

MAS-605SB



• FEATURES

16 gauge type 304 stainless steel

• TECHNICAL INFORMATION

External dimensions: 32"L x 22-1/2"W x 10"D
Basin dimensions: 30"L x 18"W x 10"D

• FINISHES

Satin Brushed stainless steel (SB)

• INSTALLATION OPTIONS

Flush installation
Under counter installation

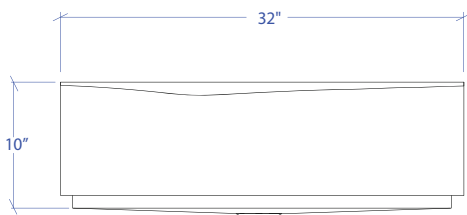
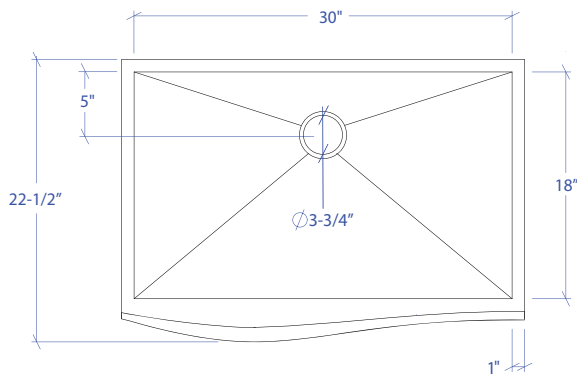

• INSTALLATION OPTIONS

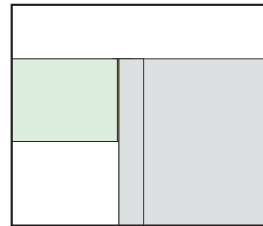

Flush Installation

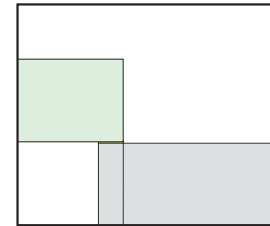

Under Installation

• ACCESSORY OPTIONS

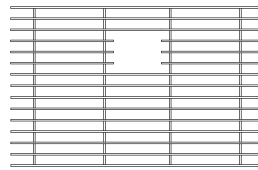

MBG-083SB
Basin Grid

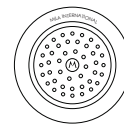

MKD-101PC
Strainer

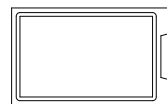

MCB-801BB
Cutting Board

PROJECT INFORMATION			
Project			
Date	/ /	QTY	
Specifier			
Contact			
Note			

APRON-FRONT