

## Step 5: SILICONE INSTALLATION

1. **MUST use 100% silicone for this installation.**
2. **Silicone must match countertop color as close as possible.**
  - \* There are many company supply and stock 100s of silicon colors. Below is one example.
- **Color Rite, Inc.** <http://www.colorriteinc.com/>
3. **NEVER USE "SILVER" SILICONE OR CLEAR SILICONE**
4. **NEVER perform this procedure outdoor and under sunlight or under rain.**
5. **If performed under extremely hot and dry climate, this step should be performed by two persons to shorten installation time.**

### 5a: BRACKET CAULKING

Apply a generous amount of 100% silicone on the top of the support bracket and on the inside edge of the countertop on all four sides. See diagram below.

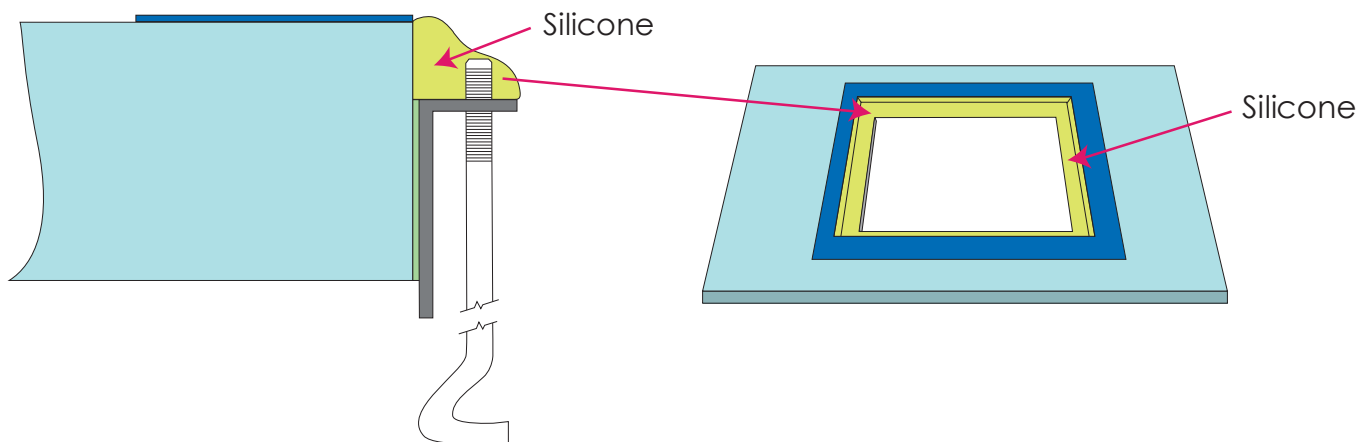

### 5b: RIM CAULKING APPLICATION

Apply a thin coat of silicon, "butter coating", on the bottom and side of the sink rim on all four sides.  
\*See diagram below.

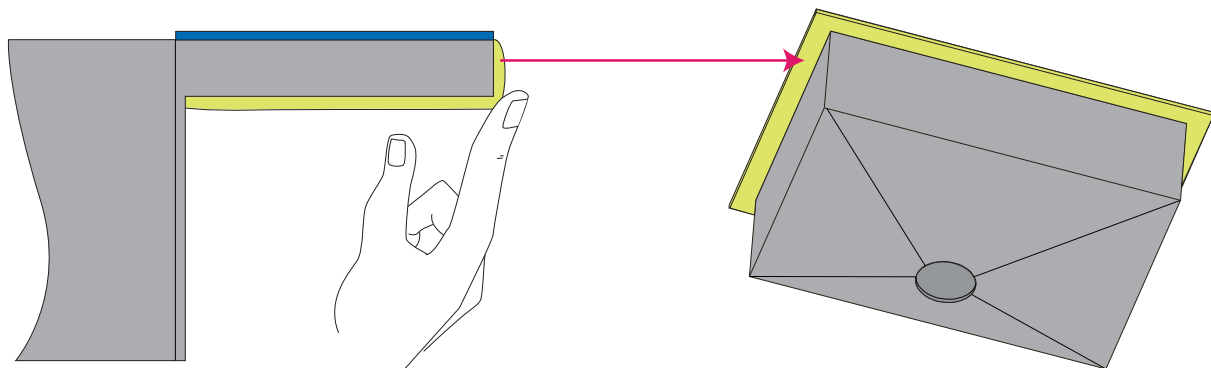

**\* Once Step 5a an 5b is completed, proceed immediately to Step 5c.**