

# LOUVRE MLFS-655GPSB

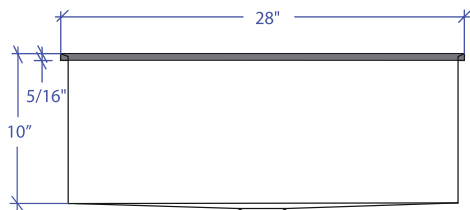

\*Flush-Mount Installation Kit is included with each sink  
\*Custom ADA compliant versions are available

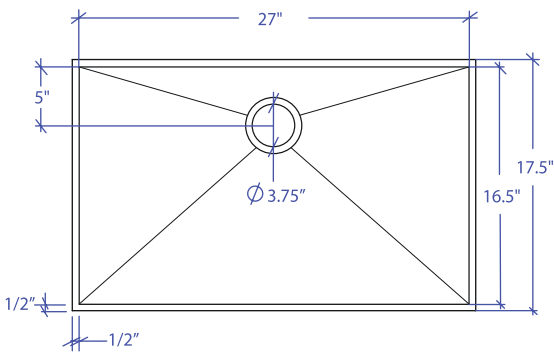

## • FEATURES

16-gauge type 304 stainless steel  
Stainless steel rim support tubing  
Bevel rim and basin design

## • TECHNICAL INFORMATION

External dimension: 28" Lx17.5" Wx10" D  
Basin dimensions: 27" Lx16.5" Wx10" D  
Rim width: 1/2"  
Rim thickness: 5/16"

## • FINISHES

Graphite PVD satin brushed stainless steel

## • INSTALLATION OPTIONS

Flush-mount

## • MINIMUM CABINET SIZE (I.D.)

Flush-mount 31"

## • INDUSTRY'S ONLY STAINLESS STEEL SINK DESIGNED SPECIFICALLY TO BE FLUSH-MOUNTED

## • INTERNATIONAL PATENT PENDING

## • FLUSH-MOUNT INSTALLATION

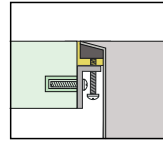

Flush-mount

## • ACCESSORIES OPTIONS

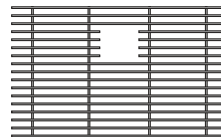

MBG-6517GPSB  
Basin Grid

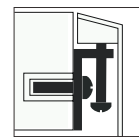

Flush Mount Kit  
(Included)  
MTK-618AL

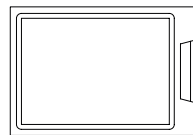

MCB-651BB  
Cutting Board

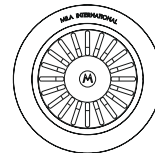

MKD-101GPSB  
Strainer

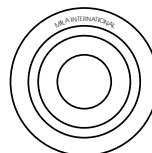

MDC-101GPSB  
Disposal Collar

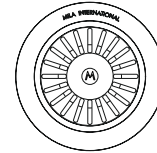

MDC-102GPSB  
Disposal Collar

## PROJECT INFORMATION

Project			
Date	/ /	QTY	
Specifier			
Contact			
Note			

FLUSH-MOUNT