

ORION MOUS-502GDSB



*Custom ADA compliant sinks are available

• FEATURES

16-gauge type 304 stainless steel
Bevel basin design

• TECHNICAL INFORMATION

External dimension: 23"Lx17.5"Wx10"D
Basin dimensions: 21"Lx15"Wx10"D
Rim width: 1"
Rim thickness: 1/16"

• FINISHES

Gold PVD Satin Brushed stainless steel

• INSTALLATION OPTIONS

Under-mount

• MINIMUM CABINET SIZE (I.D.)

Under-mount 26"

• US DESIGN PATENT D618,324 S

• DUAL-MOUNT INSTALLATION

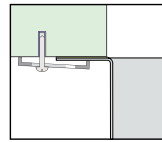

Under-mount

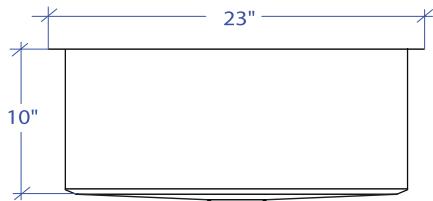
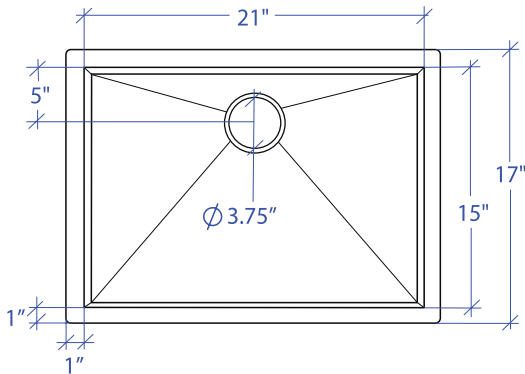

• ACCESSORY OPTIONS

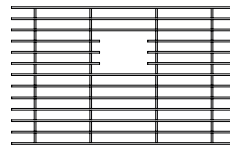

MBG-054GDSB
Basin Grid

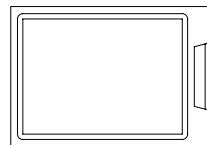

MCB-501BB
Cutting Board

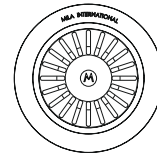

MKD-101GDSB
Strainer

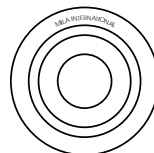

MDC-101GDSB
Disposal Collar

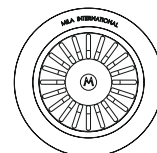

MDC-102GDSB
Disposal Collar

PROJECT INFORMATION			
Project			
Date	/ /	QTY	
Specifier			
Contact			
Note			

UNDER-MOUNT